

MARITIMO X60
SPORTS MOTOR YACHT

Maritimo
OCEANS APART





A LEGACY OF INNOVATION

Maritimo will never submit to the status quo. As innovators, we challenge conventional wisdom to materialise new ideas. We see every detail as an opportunity for excellence, and we take no short cuts in our quest to create the extraordinary.

A symphonic blend of functionality dressed in powerful form, the X Series is here to re-imagine the traditional idea of the conventional sport yacht concept. The result is nothing less than extraordinary.

Maritimo fuses its performance pedigree, bespoke materials and innovative design to create unparalleled boating luxury. With its innovative aft cabin, the X60 is a world first in its class. This re-imagined motor yacht announces the new generation of Maritimo design and is an exciting prelude of things to come.

THE ULTIMATE ENTERTAINER

The Maritimo X60 aft cabin gives owners a new level of customisation. With options designed to cater to a range of needs, it is offered in three distinct configurations: a 'beach club', an expansive tender garage or an additional queen stateroom.

Revolutionising on water entertaining the game-changing new 'beach club' design flows effortlessly into all areas of the boat, creating constant connections between guests and the sea.

Alternatively choose to use the aft cabin as a fourth cabin and experience the comfort of an additional queen stateroom with a private ensuite. Enjoy three-sided panoramic ocean views and the ability to transform the swim platform into a makeshift balcony deck with fingertip control from your bedside.



DESIGN GENETICS

Built in Australia by leading craftsmen, we are dedicated to crafting a distinctive sport yacht of the highest quality. Stemming from its illustrious Maritimo bloodline, the X-Series inherits the timeless elegance and unparalleled abilities in the water of its long range motor yacht predecessors.

Underneath the hand crafted wood, fine leather and clever ergonomics you'll find the best in nautical design that ensures simplicity, efficiency and cruisability.

When it's time for deep-water action you'll find Maritimo's racing edge more than meets the demands of the sports and high performance island hopping adventure.

X60 SPECIFICATIONS

LENGTH OVERALL	19.39 M	63' 7" FT
HULL LENGTH ISO	18.16 M	59' 7" FT
BEAM	5.2 M	17' FT
DRAFT	1.45 M	4'7" FT
DRY WEIGHT	29,000 KG	63,900 LBS
FUEL CAPACITY	4,200 L	1,110 US GAL
WATER CAPACITY	800 L	211 US GAL
HOLDING TANK CAPACITY	300 L	80 US GAL
SLEEPING CABINS	3 STANDARD	4 OPTIONAL
SLEEPING CAPACITY	6 STANDARD	8 OPTIONAL
ENGINES (STANDARD)	2 x D13 800 HP VOLVO	
GENERATOR	CUMMINS - ONAN 17.5 kW	

GENERAL ARRANGEMENT : BEACH CLUB

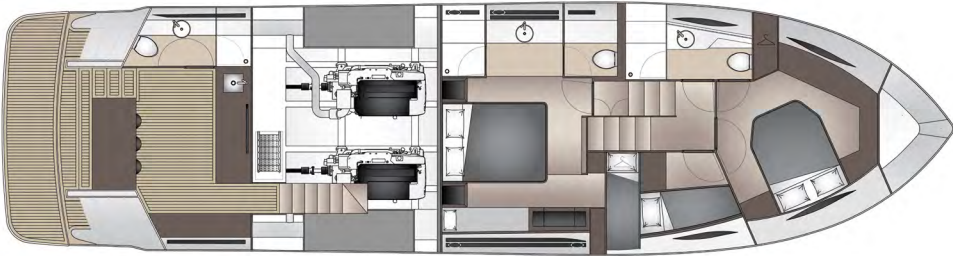

GENERAL ARRANGEMENT : AFT CABIN

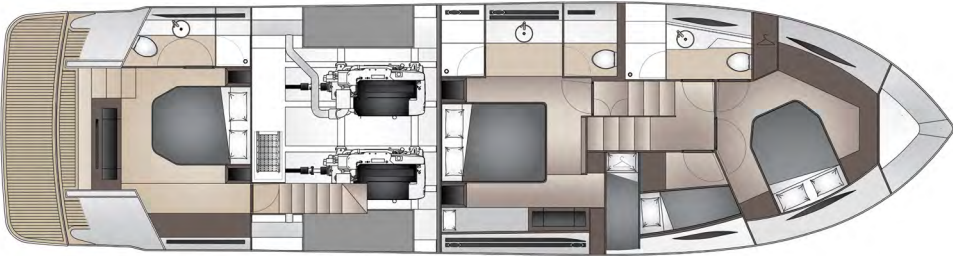

GENERAL ARRANGEMENT : TENDER GARAGE

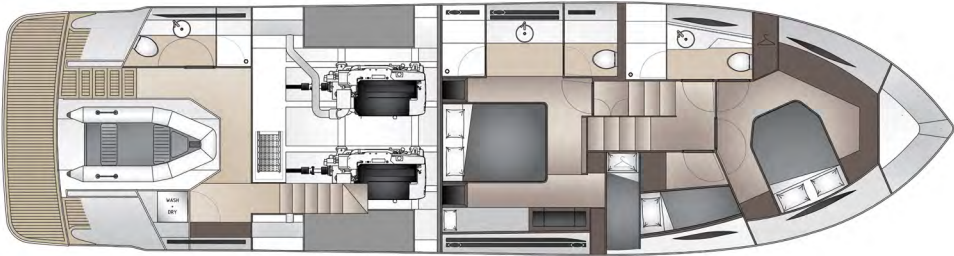



Maritimo

OCEANS APART

maritimo.com.au | [@maritimooftshore](https://www.instagram.com/maritimooftshore) | [#oceansapart](https://www.instagram.com/oceansapart)